



## Specifications:

Model		Colour code curve	Bore mm	Power output kW	Phases	r.p.m.	Head max. m	Capacity max. l/min	Starting method	Dry weight kg without cable		Impeller passage mm
free standing	with guide rail fitting									free standing	with guide rail fitting	
50SFQ2.4	-	1	50	0,4	3	2850	11,1	290	direct	20,0	-	6

**Stainless steel pump** - The SFQ pump has been developed exclusively for corrosive liquids. Applying austenitic steel in all wetted parts, the SFQ pump is a highly specialised pump in terms of design and materials.



ø Discharge bore mm		50mm		
Pumping Fluid	Temperature	0-40°C		
	Type of Fluid	Aggressive sewage		
Pump	Components	Impeller	Open type impeller	
		Shaft Seal	Double mechanical seal	
		Bearings	Shielded ball bearings	
	Material	Impeller	Stainless steel casting DIN GX5CrNiMo19-11-2	
		Casing	Stainless steel casting DIN GX5CrNiMo19-11-2	
		Suction Plate	Stainless steel casting DIN GX5CrNiMo19-11-2	
	Shaft Seal	Silicon carbide in oil bath		
Motor	Type, Poles		Induction motor, 2 poles, IP68	
	Lubrication		Turbine oil (ISO VG32)	
	Insulation		Insulation class E	
	Motor Protector (built-in)		Circle thermal cut-out	
	Phase / Voltage		3-phase / 400V / 50Hz / d.o.l.	
	Material	Casing	Stainless steel casting DIN GX5CrNiMo19-11-2	
		Shaft	Stainless steel EN-X5CrNiMo17-12-2	
Cable		Rubber, 10m H07RN-F		
Discharge Connection		Inside thread, JIS10K flange		

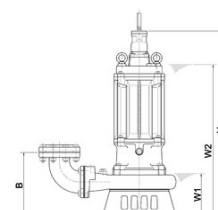
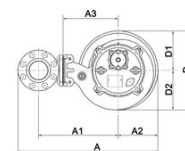
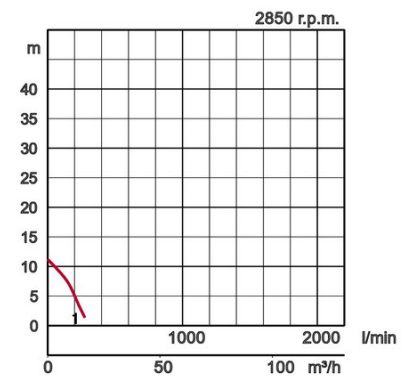

Model	A	A1	A2	B	D	D1	D2	H	W1	W2
50SFQ2.4	252	120	98	108	196	98	98	397	90	355

W1: lowest running water level