



TSURUMI PUMP

Agitator Pumps

Slurry pumps suitable for most demanding jobs.
- for professional use

Forced agitation - the agitator installed on the motor shaft extension forcibly agitates the fluid for easy and efficient transmission of sludge and slurry.



Forced agitation

The agitator installed on the motor shaft extension forcibly agitates the fluid for easy and efficient transmission of sludge and slurry.

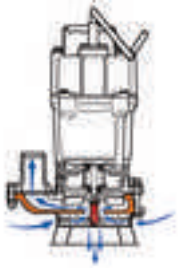

HSD

Page 3

No wear plate to replace. Impeller and agitator made of chromium iron casting, pump casing made of ductile iron casting.



KTV2

Page 4

Special alloy rubber used for casing, high-chromium cast iron used for impeller. Simple maintenance - the pump's lower part can be disassembled with a box wrench for effortless maintenance without impeller removal.

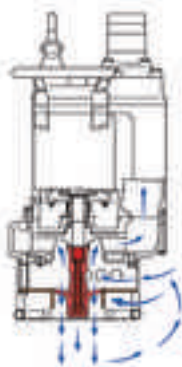

KRS2

Page 5

4-pole motor used to achieve a simple structure that demonstrates excellent durability and versatility. By offering a cast iron pump body durability is increased over standard aluminium body pumps.

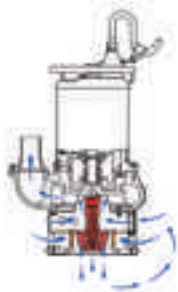

GPN

Page 6

A special-steel impeller and suction plate have greatly increased the pump's life. The casing is designed to have wide passing area, thorough thickness and antiabrasion material. 4-pole motor used to achieve a simple structure that demonstrates excellent durability and versatility. Spiral structure, marvelously facilitates the passage of sand, soil, sludge, or slime - without clogging.



NKZ

Page 7

All pumps in this series provide very smooth passage of sandy earth and slime. A forcibly cooled motor ensures long and continuous pump operations exposed to the air. 4-pole motor used to achieve excellent durability and versatility. By offering a cast iron pump body durability is increased over standard aluminium body pumps.

| Type | Model | øDischarge bore | Motor output kW | Poles | Impeller | Level sensor | Motor protector (built-in) | Flow arrangement | | | |
|-------------------------------|-------|-----------------|-----------------|-------|----------|--------------|----------------------------|------------------|---------------------------|------------------------------|--------|
| | | | | | | | | Top discharge | Top discharge (side flow) | Side discharge (spiral type) | |
| Portable 1ph/230V 1ph/110V | HSD | 50 | 0,55 | 2 | Vortex | | ○ | | | ○ | Page 3 |
| Slurry, Bentonite | KTV2 | 50 · 80 | 2,0 · 3,0 | 2 | Vortex | | ○ | | ○ | | Page 4 |
| | KRS2 | 80 - 150 | 4,0 - 9,0 | 4 | Vortex | | ○ | | ○ | | Page 5 |
| Sand | GPN | 80 · 100 | 5,5 · 11,0 | 4 | Vortex | | ○ | | | ○ | Page 6 |
| | NKZ | 80 · 100 | 2,2 - 11,0 | 4 | Vortex | | ○ | | | ○ | Page 7 |

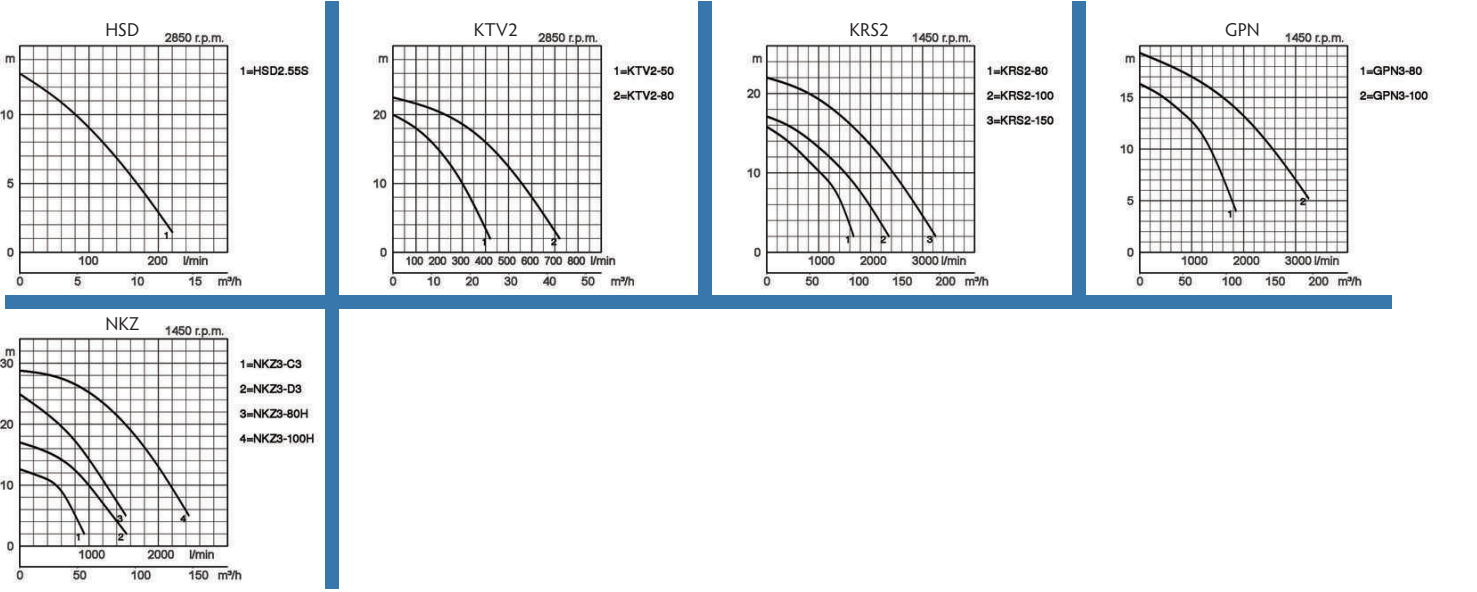

Specifications:

| Model | Colour code curve | Bore mm | Motor output kW | Rated current A | Head max. m | Capacity max. l/min | Dry weight kg w/o cable | Max. solid handling ø mm | Max. water depth m | Cable length m |
|---------|-------------------|---------|-----------------|-----------------|-------------|---------------------|-------------------------|--------------------------|--------------------|----------------|
| KTV2-50 | 1 | 50 | 2,0 | 3,8 | 20,0 | 420 | 25,0 | 10 | 25 | 20 |
| KTV2-80 | 2 | 80 | 3,0 | 6,1 | 22,5 | 720 | 38,0 | 10 | 25 | 20 |

Light Weight Bentonite Pump

A powerful slurry pump using KTV pumps as a base. Features wear resistance, durability and extra light weight.



| | | | |
|----------------------|----------------------------|--|-----------------------------|
| ø Discharge bore mm | | 50, 80 | |
| Pumping Fluid | Temperature | 0-40°C | |
| | Type of Fluid | Sludge, Slurry, Liquids containing mud | |
| Pump | Components | Impeller | Semi-Vortex impeller |
| | | Shaft Seal | Double mechanical seal |
| | | Bearings | Shielded ball bearings |
| | Material | Impeller | Chromium iron casting |
| | | Casing | Synthetic rubber |
| | | Shaft Seal | Silicon carbide in oil bath |
| Motor | Type, Poles | Induction motor, 2 poles, IP68 | |
| | Lubrication | Turbine oil (ISO VG32) | |
| | Motor Protector (built-in) | Circle thermal cut-out | |
| | Insulation | Insulation class E | |
| | Phase / Voltage | 3-phase / 400V / 50Hz / d.o.l. | |
| | Material | Casing | Aluminium die casting |
| | | Shaft | Stainless steel EN-X6Cr13 |
| Cable | | Rubber, H07RN-F | |
| Discharge Connection | | Threaded flange/Hose coupling | |

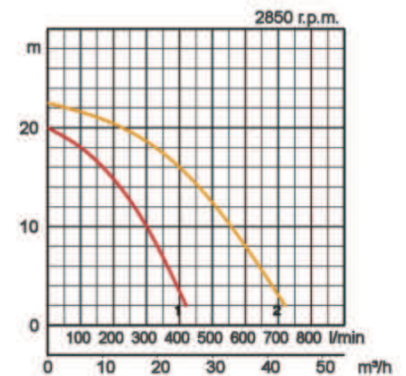

Dimensions in mm:

| Model | A | A1 | B | B1 | D | H | W1 |
|---------|-----|-----|-----|-----|-----|-----|-----|
| KTV2-50 | 250 | 192 | 450 | 368 | 250 | 454 | 120 |
| KTV2-80 | 295 | 216 | 550 | 427 | 295 | 550 | 130 |

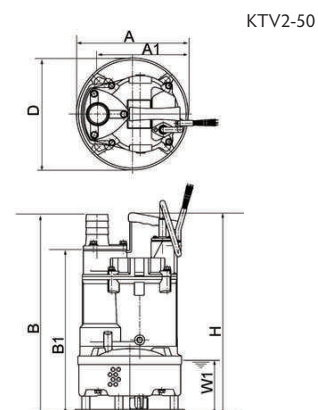
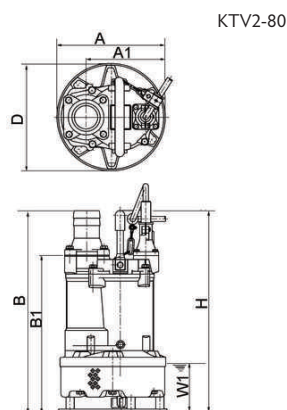

W1: continuous running water level

In the event of abrasive and corrosive utilization, stronger wear and tear will take place naturally in certain components. In this regard, please pay attention to our website www.tsurumi.eu/english/applications.htm.

Specifications:

| Model | Colour code curve | Bore mm | Motor output kW | Rated current A | Head max. m | Capacity max. l/min | Dry weight kg w/o cable | Max. solid handling ø mm | Max. water depth m | Cable length m |
|----------|-------------------|---------|-----------------|-----------------|-------------|---------------------|-------------------------|--------------------------|--------------------|----------------|
| KRS2-80 | 1 | 80 | 4,0 | 9,5 | 15,8 | 1670 | 105,0 | 30 | 15 | 20 |
| KRS2-100 | 2 | 100 | 6,0 | 13,0 | 17,1 | 2350 | 145,0 | 30 | 15 | 20 |
| KRS2-150 | 3 | 150 | 9,0 | 18,5 | 22,0 | 3250 | 170,0 | 30 | 15 | 20 |

Heavy Duty Slurry Pump

Tsurumi's typical slurry pumps with a 4-pole motor for an increased lifetime and greater convenience.



| | | | | |
|----------------------|-----------------------------|---|------------------------------|--|
| ø Discharge bore mm | | 80, 100, 150 | | |
| Pumping Fluid | Temperature | 0-40°C | | |
| | Type of Fluid | Sludge, Slurry, Liquids containing sandy mud and/or bentonite | | |
| Pump | Components | Impeller | Open type impeller | |
| | | Shaft Seal | Double mechanical seal | |
| | | Bearings | Shielded ball bearings | |
| | Material | Impeller | Chromium iron casting | |
| | | Casing | Grey iron casting EN-GJL-200 | |
| | | Suction Plate | Chromium iron casting | |
| Shaft Seal | Silicon carbide in oil bath | | | |
| Motor | Type, Poles | Induction motor, 4 poles, IP68 | | |
| | Lubrication | Turbine oil (ISO VG32) | | |
| | Motor Protector (built-in) | Circle thermal cut-out | | |
| | Insulation | Insulation class E, Insulation class B | | |
| | Phase / Voltage | 3-phase / 400V / 50Hz / d.o.l. | | |
| | Material | Casing | Grey iron casting EN-GJL-150 | |
| | | Shaft | Stainless steel EN-X30Cr13 | |
| Cable | | Rubber, H07RN-F | | |
| Discharge Connection | | Threaded flange/Hose coupling | | |

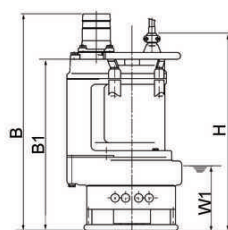
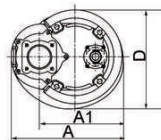
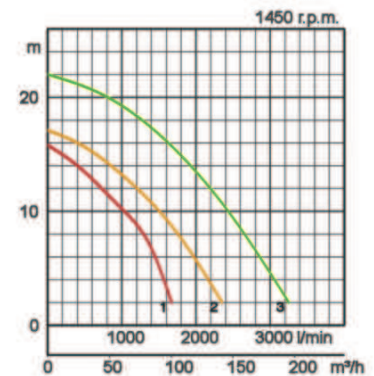

Dimensions in mm:

| Model | A | A1 | B | B1 | D | H | W1 |
|----------|-----|-----|-----|-----|-----|-----|-----|
| KRS2-80 | 350 | 260 | 786 | 666 | 326 | 766 | 250 |
| KRS2-100 | 415 | 305 | 815 | 678 | 373 | 754 | 250 |
| KRS2-150 | 434 | 324 | 879 | 699 | 407 | 811 | 250 |

W1: continuous running water level

In the event of abrasive and corrosive utilization, stronger wear and tear will take place naturally in certain components. In this regard, please pay attention to our website www.tsurumi.eu/english/applications.htm.

Specifications:

| Model | Colour code curve | Bore mm | Motor output kW | Rated current A | Head max. m | Capacity max. l/min | Dry weight kg w/o cable | Max. solid handling ø mm | Max. water depth m | Cable length m |
|----------|-------------------|---------|-----------------|-----------------|-------------|---------------------|-------------------------|--------------------------|--------------------|----------------|
| GPN3-80 | 1 | 80 | 5,5 | 12,1 | 16,3 | 1900 | 145,0 | 30 | 20 | 20 |
| GPN3-100 | 2 | 100 | 11,0 | 22,0 | 19,3 | 3250 | 217,0 | 30 | 20 | 20 |

Heavy Duty Sand Pump

A special steel impeller and suction plate have greatly increased the pump's life. The casing is designed to have wide passing area, thorough thickness and anti-abrasion material.



| | | | |
|----------------------|-----------------------------|---|--|
| ø Discharge bore mm | | 80, 100 | |
| Pumping Fluid | Temperature | 0-40°C | |
| | Type of Fluid | Sludge, Slurry, Liquids containing sandy mud and/or bentonite | |
| Pump | Components | Impeller | Open type impeller |
| | | Shaft Seal | Double mechanical seal |
| | | Bearings | Shielded ball bearings |
| | Material | Impeller | Chromium iron casting |
| | | Casing | Grey iron casting EN-GJL-200 |
| | | Suction Plate | Chromium iron casting |
| Shaft Seal | Silicon carbide in oil bath | | |
| Motor | Type, Poles | | Induction motor, 4 poles, IP68 |
| | Lubrication | | Turbine oil (ISO VG32) |
| | Motor Protector (built-in) | | Circle thermal cut-out |
| | Insulation | | Insulation class E, Insulation class B |
| | Phase / Voltage | | 3-phase / 400V / 50Hz / d.o.l. |
| | Material | Casing | Grey iron casting EN-GJL-150 |
| | | Shaft | Chromium-molybdenum steel (DIN 1.7220) |
| Cable | | Rubber, H07RN-F | |
| Discharge Connection | | Threaded flange/Hose coupling | |

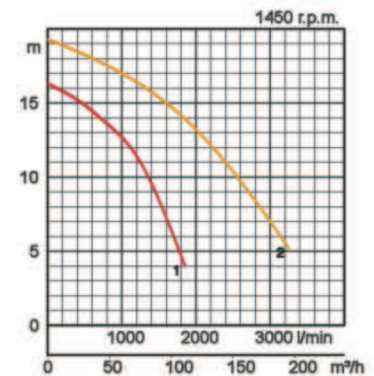

Dimensions in mm:

| Model | A | A1 | B | B1 | D | H | W1 |
|----------|-----|-----|-----|-----|-----|-----|-----|
| GPN3-80 | 487 | 426 | 429 | 307 | 390 | 777 | 270 |
| GPN3-100 | 617 | 517 | 481 | 328 | 450 | 860 | 295 |

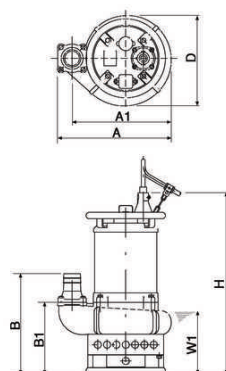

W1: continuous running water level

In the event of abrasive and corrosive utilization, stronger wear and tear will take place naturally in certain components. In this regard, please pay attention to our website www.tsurumi.eu/english/applications.htm.

Specifications:

| Model | Colour code curve | Bore mm | Motor output kW | Rated current A | Head max. m | Capacity max. l/min | Dry weight kg w/o cable | Max. solid handling ø mm | Max. water depth m | Cable length m |
|-----------|-------------------|---------|-----------------|-----------------|-------------|---------------------|-------------------------|--------------------------|--------------------|----------------|
| NKZ3-C3 | 1 | 80 | 2,2 | 5,1 | 12,6 | 930 | 91,0 | 30 | 15 | 20 |
| NKZ3-D3 | 2 | 80 | 3,7 | 8,0 | 17,0 | 1540 | 100,0 | 30 | 15 | 20 |
| NKZ3-80H | 3 | 80 | 5,5 | 12,1 | 24,9 | 1530 | 132,0 | 20 | 15 | 20 |
| NKZ3-100H | 4 | 100 | 11,0 | 22,0 | 28,8 | 2440 | 196,0 | 20 | 15 | 20 |

All Purpose Sand Pumps

All pumps in this series provide very smooth passage of sandy earth and slime. A forcibly cooled motor ensures long and continuous pump operations exposed to the air.



| | | | | |
|----------------------|-----------------------------|---|---|--|
| ø Discharge bore mm | | 80, 100 | | |
| Pumping Fluid | Temperature | 0-40°C | | |
| | Type of Fluid | Liquids containing sandy mud, Sand carrying water | | |
| Pump | Components | Impeller | Open type impeller | |
| | | Shaft Seal | Double mechanical seal | |
| | | Bearings | Shielded ball bearings | |
| | Material | Impeller | Ductile iron casting EN-GJS-700-2, Chromium iron casting | |
| | | Casing | Grey iron casting EN-GJL-200 | |
| | | Suction Plate | Grey iron casting EN-GJL-200, Ductile iron casting EN-GJS-700-2 | |
| Shaft Seal | Silicon carbide in oil bath | | | |
| Motor | Type, Poles | Induction motor, 4 poles, IP68 | | |
| | Lubrication | Turbine oil (ISO VG32) | | |
| | Motor Protector (built-in) | Circle thermal cut-out | | |
| | Insulation | Insulation class E, Insulation class B | | |
| | Phase / Voltage | 3-phase / 400V / 50Hz / d.o.l. | | |
| | Material | Casing | Grey iron casting EN-GJL-150 | |
| Shaft | | Stainless steel EN-X30Cr13 | | |
| Cable | | Rubber, H07RN-F | | |
| Discharge Connection | | Threaded flange/Hose coupling | | |

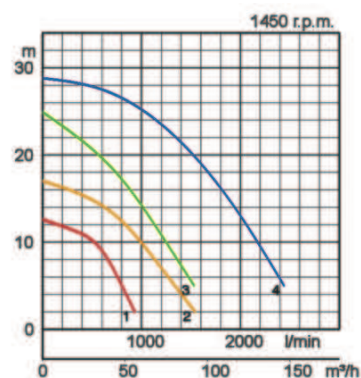

Dimensions in mm:

| Model | d | A | A1 | B | B1 | D | H | W1 |
|-----------|-----|-----|-----|-----|-----|-----|-----|-----|
| NKZ3-C3 | 80 | 467 | 405 | 371 | 249 | 370 | 664 | 225 |
| NKZ3-D3 | 80 | 467 | 405 | 371 | 249 | 370 | 664 | 225 |
| NKZ3-80H | 80 | 491 | 430 | 387 | 264 | 401 | 754 | 220 |
| NKZ3-100H | 100 | 547 | 486 | 422 | 284 | 414 | 841 | 240 |

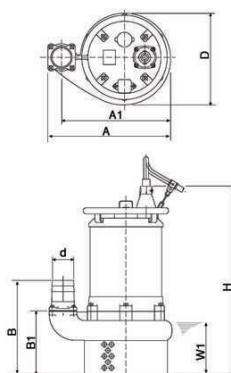

W1: continuous running water level

In the event of abrasive and corrosive utilization, stronger wear and tear will take place naturally in certain components. In this regard, please pay attention to our website www.tsurumi.eu/english/applications.htm.



Contributing to World-wide Prosperity and Understanding through Worker- and Environment-friendly Production.

Designed for increased productivity through fully integrated streamlined production systems, Tsurumi's factory in Kyoto (Japan) features a production capacity of a full 1 million pumps per year. Large-scale modern R&D facilities offer optimum conditions for experimenting and testing of even super-large pumps and for developing new products to expand the possibilities and applications of pumps. To provide optimum conditions for our main asset, our workers, as well as for the environment, special emphasis is placed on optimized working conditions with airconditioning, minimized dust and exhaust gas emission, comprehensive recycling and waste recovery.

Tsurumi (Europe) GmbH

Heltorfer Straße 14
D-40472 Düsseldorf
Tel.: +49 (0)211-4179373
Fax: +49 (0)211-4791429
Email: sales@tsurumi.eu
www.tsurumi.eu

We reserve the right to change specifications and designs herein for improvement without prior notice. Our pumps are for professional use only. In the event that Tsurumi (Europe) GmbH have, in exceptional cases taken over, a manufacturer's warranty, this entitles the enduser to assert remedy free of charge against Tsurumi (Europe) GmbH due to any defect to the product occurring during the guarantee period (see below), also then when the warranty claims against the seller do not or no longer exist. In the event of malfunction, which is attributable to the improper handling by the enduser, no guarantee claim shall arise. Further claims shall not result from the warranty, unless if something to the contrary has explicitly been determined. The decision as to whether remedy is effected by way of replacement or repair shall be at the choice of Tsurumi (Europe) GmbH. The claims shall be time barred after a period of three months after expiry of the guarantee period, however, not before expiry of the warranty period which is valid towards the seller. In the event of doubt, the warranty period shall correspond with the warranty period which is valid between the end-user and his seller.



con-agitator-EN

